

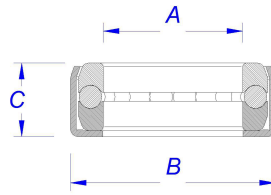

CMM Italy

# Stamped axial (thrust) ball bearings

Axial bearing, forged steel. Cheap thanks to a production process very fast. Suitable to withstand high loads at low rpm. The hardening of the sheet, combined with the heat treatment of the parts in contact with the balls and the galvanic protection of components make it extremely powerful being able to express excellent mechanical properties. On request the certificate of the product is available.



**APPLICATIONS:**

- INDUSTRIAL DOORS
- DOOR AND WINDOW HINGES
- FIRE DOOR HINGES
- SWIVEL CHAIRS
- TRIPODS
- REVOLVING DISPLAY BOARDS

**SURFACE TREATMENT:** WHITE GALVANIZED; GALVANIZED YELLOW; GALVANIZED BLACK; GILDED; NICKEL COATED; BRONZED.

CODE	DESCRIPTION	DIMENSION			MATERIAL			DYNAMIC LOAD DaN (steel)*
		A	B	C	steel	stainless Steel	brass	
RS12½X5F6	STAMPED THRUST B. BEARING Ø12,5X5 BORE 6	6,2	12	5	•	•		100
RS12½X5,6F6	STAMPED THRUST B. BEARING Ø12,5X5,6 FORO 6	6,2	12	5,6	•	•	•	100
RS13X5.6F7	STAMPED THRUST B. BEARING Ø13X5.6 FORO 7	7,2	13	5,6	•	•	•	200
RS13X6,6F7	STAMPED THRUST B. BEARING Ø13X6,6 FORO 7	7,2	13	6,6	•	•		200
RS13X7F7	STAMPED THRUST B. BEARING Ø13X7 FORO 7	7,2	13	7	•		•	200
RS14X5.6F7	STAMPED THRUST B. BEARING Ø14X5,6 FORO 7	7,2	14	5,6	•		•	250
RS15X5.6F8	STAMPED THRUST B. BEARING Ø15X5,6 FORO 8	8,2	15	5,6	•		•	300
RS15X5.6F9	STAMPED THRUST B. BEARING Ø15X5,6 FORO 9	9,2	15	5,6	•			300
RS15X6½F7	STAMPED THRUST B. BEARING Ø15X6,5 FORO 7	7,2	15	6,5	•			300
RS15X7F8	STAMPED THRUST B. BEARING Ø15X7 FORO 8	8,2	15	7	•			300
RS16X4.3F10	STAMPED THRUST B. BEARING Ø16X4.3 FORO 10	10,2	16	4,3		•	•	
RS16X6F10	STAMPED THRUST B. BEARING Ø16X6 FORO 10	10,2	16	6		•		
RS16X8F10	STAMPED THRUST B. BEARING Ø16X8 FORO 10	10,2	16	8	•	•		400
RS16½X6½F10	STAMPED THRUST B. BEARING Ø16,5X6,5 FORO 10	10,2	16,5	6,5	•		•	200
RS16½X7F8	STAMPED THRUST B. BEARING Ø16,5X7 FORO 8	8,2	16,5	7	•	•		300
RS17½X6F9	STAMPED THRUST B. BEARING Ø17,5X6 FORO 9	9,2	17,5	6	•			500
RS17½X6F10	STAMPED THRUST B. BEARING Ø17,5X6 FORO 10	10,2	17,5	6	•	•		500
RS17½X7½F8½	STAMPED THRUST B. BEARING Ø17,5X7,5 FORO 8,5	8,5	17,5	7,5	•			400
RS17½X7½F9	STAMPED THRUST B. BEARING Ø17,5X7,5 FORO 9	9,2	17,5	7,5	•			400
RS19X4.3F11	STAMPED THRUST B. BEARING Ø19X4,3 FORO 11	11,2	19	4,3		•		
RS19X6½F11	STAMPED THRUST B. BEARING Ø19X6,5 FORO 11	11,2	19	6,5	•			700
RS20X6½F10	STAMPED THRUST B. BEARING Ø20X6,5 FORO 10	10,2	20	6,5	•		•	800
RS20X6½F11	STAMPED THRUST B. BEARING Ø20X6,5 FORO 11	11,2	20	6,5	•			800
RS20X6½F12	STAMPED THRUST B. BEARING Ø20X6,5 FORO 12	12,2	20	6,5	•	•		800
RS20X7F11	STAMPED THRUST B. BEARING Ø20X7 FORO 11	11,4	20	7	•			800
RS20X8½F12	STAMPED THRUST B. BEARING Ø20X8,5 FORO 12	12,2	20	8,5	•			800
RS21X6½F13	STAMPED THRUST B. BEARING Ø21X6,5 FORO 13	13,2	21	6,5	•			800
RS22X6.7F14	STAMPED THRUST B. BEARING Ø22X6.7 FORO 14	14,2	22	6,7	•	•		800
RS22X7.9F13	STAMPED THRUST B. BEARING Ø22X7,9 FORO 13	13,4	22	7,9	•	•		800
RS24X7½F16	STAMPED THRUST B. BEARING Ø24X7,5 FORO 16	16,2	24	7,5	•			850
RS25X6.5F10	STAMPED THRUST B. BEARING Ø25X6,5 FORO 10	10,2	25	6,5		•		
RS25X6.5F11	STAMPED THRUST B. BEARING Ø25X6,5 FORO 11	11,2	25	6,5		•		
RS25X6.5F14	STAMPED THRUST B. BEARING Ø25X6,5 FORO 14	14,2	25	6,5		•		
RS25X8F14	STAMPED THRUST B. BEARING Ø25X8,3 FORO 14	14,3	25	8,3	•	•	•	500
RS25X10F14	STAMPED THRUST B. BEARING Ø25X10,3 FORO 14	14,3	25	10,3	•			500
RS26X5,6F17	STAMPED THRUST B. BEARING Ø26X5,6 FORO 17	17,2	26	5,6	•			300
RS27X6½F16	STAMPED THRUST B. BEARING Ø27X6,5 FORO 16	16,2	27	6,5	•			850
RS27X6½F18	STAMPED THRUST B. BEARING Ø27X6,5 FORO 18	18,2	27	6,5	•			850
RS27X9F16	STAMPED THRUST B. BEARING Ø27X9 FORO 16	16,2	27	9	•			850
RS28½X10F19,4	STAMPED THRUST B. BEARING Ø28,5X10 FORO 19,4	19,4	28	10	•			1000
RS29X6½F20	STAMPED THRUST B. BEARING Ø29X6,5 FORO 20	20,2	29	6,5	•			1000
RS32X6½F20	STAMPED THRUST B. BEARING Ø32X6,5 FORO 20	20,2	32	6,5	•			1000
RS32X7F20	STAMPED THRUST B. BEARING Ø32X7 FORO 20	20,2	32	7	•			1000
RS32X8F20	STAMPED THRUST B. BEARING Ø32X8 FORO 20	20,2	32	8	•	•		1000
RS33X10F18,5	STAMPED THRUST B. BEARING Ø33X10 FORO 18,5	18,5	33	10	•			1000
RS36X11F20	STAMPED THRUST B. BEARING Ø36X11 FORO 20	20,2	36	11	•			1000
RS38X12F25	STAMPED THRUST B. BEARING 38X12 FORO 25	25,2	38	12	•			1000
RS40X11F25	STAMPED THRUST B. BEARING Ø40X11 FORO 25	25,2	40	11	•			1000

\*The capacity refers only to steel bearings

**CMM ITALY SRL**

30030 Mellaredo di Pianiga (VE) Via Tagliamento, 10 - Tel. 041 5190344 - Fax 0415194646

Mail: [info@cmmitaly.com](mailto:info@cmmitaly.com) - [www.cmmitaly.com](http://www.cmmitaly.com)